

Coplas e Hidrocoplas



Los acoples flexibles Victaulic, tales como los Estilos 75, 77, 177, 177N y W77, 995, 997 para la tubería IPS, y acoples Estilo 31 acoplados con una tubería AWWA de hierro dúctil ranurada por corte, permite el movimiento controlado por tubería dentro de los acoples mientras mantiene un sello positivo y una unión auto-contenida.

El diseño permite expansión, contracción y deflexión generada por cambios térmicos, construcciones o asentamiento terrestre y actividad sísmica.



Typical 1 – 12*

Nominal Size	Actual Outside Diameter	Maximum Working Pressure ²	Maximum End Load ²	Allow. Pipe End Separation ³	Bolt/Nut ⁴	Dimensions			Approx. Weight Each
						X	Y	Z	
inches mm	inches mm	psi kPa	lbs. N	inches mm	No. – size inches	inches mm	inches mm	inches mm	lbs. kg
1 25	1.315 33.7	750 5175	650 2890	0.05 1.2	2 – 3/8 x 2	2.36 60	4.22 107	1.84 47	1.6 0.7
1 1/4 32	1.660 42.4	750 5175	1,620 7210	0.05 1.2	2 – 3/8 x 2	2.69 68	4.62 117	1.84 47	1.6 0.7
1 1/2 40	1.900 48.3	750 5175	2,130 9480	0.05 1.2	2 – 3/8 x 2	2.94 75	5.81 148	1.84 47	1.6 0.7
2 50	2.375 60.3	750 5175	3,320 14775	0.07 1.7	2 – 1/2 x 2 1/2	3.35 85	5.78 147	1.84 47	2.3 1.0
2 1/2 65	2.875 73.0	750 5175	4,875 21695	0.07 1.7	2 – 1/2 x 2 3/4	3.88 98	6.38 162	1.84 47	2.6 1.2
76.1 mm	3.000 76.1	750 5175	5,300 23585	0.07 1.7	2 – 12 x 70.0	4.21 107	6.61 168	1.84 47	3.6 1.6
3 80	3.500 88.9	750 5175	7,215 32105	0.07 1.7	2 – 1/2 x 2 1/2	4.54 115	6.81 173	1.84 47	3.0 1.4
4 100	4.500 114.3	750 5175	11,925 53065	0.16 4.1	2 – 1/2 x 2 3/4	5.81 148	8.21 209	2.07 53	5.3 2.4
108.0 mm	4.250 108.0	750 5175	10,635 47325	0.16 4.1	2 – 12 x 70.0	5.56 141	7.98 203	2.07 53	5.2 2.4
5 125	5.563 141.3	750 5175	18,225 81100	0.16 0.2	2 – 3/8 x 3 1/4	7.03 179	9.89 251	2.07 53	7.4 3.4
133.0 mm	5.250 133.0	700 4825	15,145 67395	0.16 4.1	2 – 16 x 82.5	6.69 170	9.60 244	2.07 53	7.4 3.4
139.7 mm	5.500 139.7	700 4825	16,625 73980	0.16 4.1	2 – 16 x 82.5	6.94 176	9.82 249	2.07 53	7.6 3.4
6 150	6.625 168.3	700 4825	24,130 107380	0.16 4.1	2 – 3/8 x 3 1/4	8.26 210	10.83 275	2.07 53	8.3 3.8
159.0 mm	6.250 159.0	700 4825	21,465 95520	0.16 4.1	2 – 16 x 82.5	7.84 199	10.54 268	2.07 53	9.2 4.2
165.1 mm	6.500 165.1	700 4825	23,225 103305	0.16 4.1	2 – 16 x 82.5	8.13 207	10.84 275	2.07 53	8.3 3.8
8 5 200	8.625 219.1	600 4130	35,000 155750	0.19 4.8	2 – 3/4 x 4 1/4	10.54 268	13.74 349	2.51 64	15.1 6.8
10 5 250	10.750 273.0	500 3450	45,400 202030	0.13 3.3	2 – 7/8 x 6 1/2	12.86 327	16.98 431	2.56 65	23.5 10.7
12 5 300	12.750 323.9	400 2750	51,000 226950	0.13 3.3	2 – 7/8 x 6 1/2	14.86 377	18.88 480	2.56 65	28.2 12.8

Teléfonos: (01) 685 0148 / 989 091 617

operaciones@serproindsac.com / ventas@serproindsac.com

www.serproindsac.com

DIMENSIONS

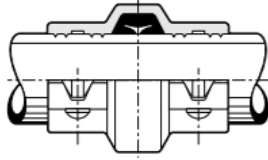
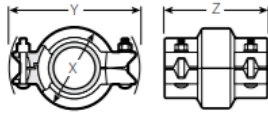

Exaggerated for clarity

**3 - 12"/(80 - 300 MM SIZES
(2"750 MM & 63 MM HAS 1 BOLT PER SIDE)**

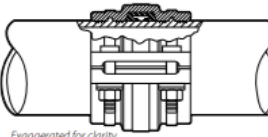
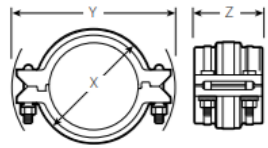

Exaggerated for clarity

14 - 20"/350 - 500 MM SIZES

Pipe Size		Coupling Dim. Inches/mm			Bolt/Nut No. - Size		Aprx. Wgt. Ea.
Nom. Dia. In./mm	Actual Out. Dia. In./mm	X	Y	Z	Inches		Lbs. kg
2 50	2.375 60.3	3.34 85	6.25 159	3.63 92	2 - 1/2 x 3		4.0 1.8
63 †	63.6	88	162	92	2 - M12 x 76 Lg.		1.7
3 80	3.500 88.9	4.58 116	7.15 182	4.56 116	4 - 1/2 x 3 1/4		8.2 3.7
90 †	90.9	116	182	116	4 - M12 x 83 Lg.		3.7
110 †	111.0	145	207	145	4 - M12 x 83 Lg.		5.5
4 100	4.500 114.3	5.88 149	8.25 210	5.75 146	4 - 1/2 x 3 1/4		12.5 5.7
125 †	126.2	161	220	146	4 - M12 x 83 Lg.		5.8
140 †	141.3	176	259	149	4 - M16 x 102 Lg.		7.1
5 125	5.563 141.3	6.94 176	10.19 259	5.88 149	4 - 5/8 x 4		15.7 7.1
6 150	6.625 168.3	8.00 203	11.13 283	5.88 149	4 - 5/8 X 4		16.4 7.4
160 †	161.5	194	276	149	4 - M16 x 102 Lg.		7.7
180 †	181.7	217	303	149	4 - M16 x 102 Lg.		8.8
200 †	201.8	240	336	152	4 - M16 x 102 Lg.		10.9
225 †	227.1	265	345	152	4 - M16 x 102 Lg.		11.9
8 200	8.625 219.1	10.50 267	13.50 343	6.00 152	4 - 5/8 x 4 1/4		26.9 12.2
250 †	252.3	293	405	165	4 - M20 x 159 Lg.		19.1

Pipe Size		Coupling Dim. Inches/mm			Bolt/Nut No. - Size		Aprx. Wgt. Ea.
Nom. Dia. In./mm	Actual Out. Dia. In./mm	X	Y	Z	Inches		Lbs. kg
10 250	10.750 273.0	12.38 314	16.63 422	6.50 165	4 - 3/4 x 6 1/4		38.0 17.2
280 †	282.6	321	430	165	4 - M20 x 159 Lg.		20.7
315 †	317.9	356	468	178	4 - M22 x 165 Lg.		24.5
12 300	12.750 323.9	14.38 365	18.75 476	7.00 178	4 - 7/8 x 6 1/2		47.8 21.7
355 †	358.2	413	559	218	4 - M24 x 178 Lg.		38.6
14 350	14.000 355.6	16.25 413	22.00 559	8.58 218	4 - 1 x 7 5/8		72.0 32.7
400 †	403.6	465	612	229	4 - M24 x 178 Lg.		45.4
16 400	16.000 406.4	18.25 464	24.13 613	9.00 229	4 - 1 x 7 5/8		100.0 45.5
450 †	454.1	516	660	241	4 - M24 x 178 Lg.		56.7
18 450	18.000 457.0	20.25 514	26.00 660	9.50 241	4 - 1 x 7 5/8		125.0 56.7
500 †	504.5	566	706	254	4 - M24 x 178 Lg.		63.5
20 500	20.000 508.0	22.25 565	27.75 705	10.00 254	4 - 1 x 7 5/8		140.0 63.5



Teléfonos: (01) 685 0148 / 989 091 617

operaciones@serproindsac.com / ventas@serproindsac.com

www.serproindsac.com